

Rolfe East



Corringway, Ealing, W5 3AB

£1,625 pcm

- Contemporary studio apartments
- All bills included
- Residents lounge
- Parquet wood flooring throughout
- Parking available by negotiation
- Exclusive modern development
- Gas central heating and double glazed windows
- En-suite shower rooms
- Access to large private gardens
- Utility room/washing machine/tumble dryer

11 Corringway, Ealing W5 3AB

ALL BILLS INCLUDED: A stunning new small development of studio apartments in this highly regarded, and quiet residential area, just minutes from Ealing Broadway. Finished to a very high contemporary standard throughout and available furnished or unfurnished, these individual and independent studio apartments enjoy access to a large kitchen, residents lounge, utility room, large garden. Prices start from £1625 pcm with some rooms available for couples.



Council Tax Band:



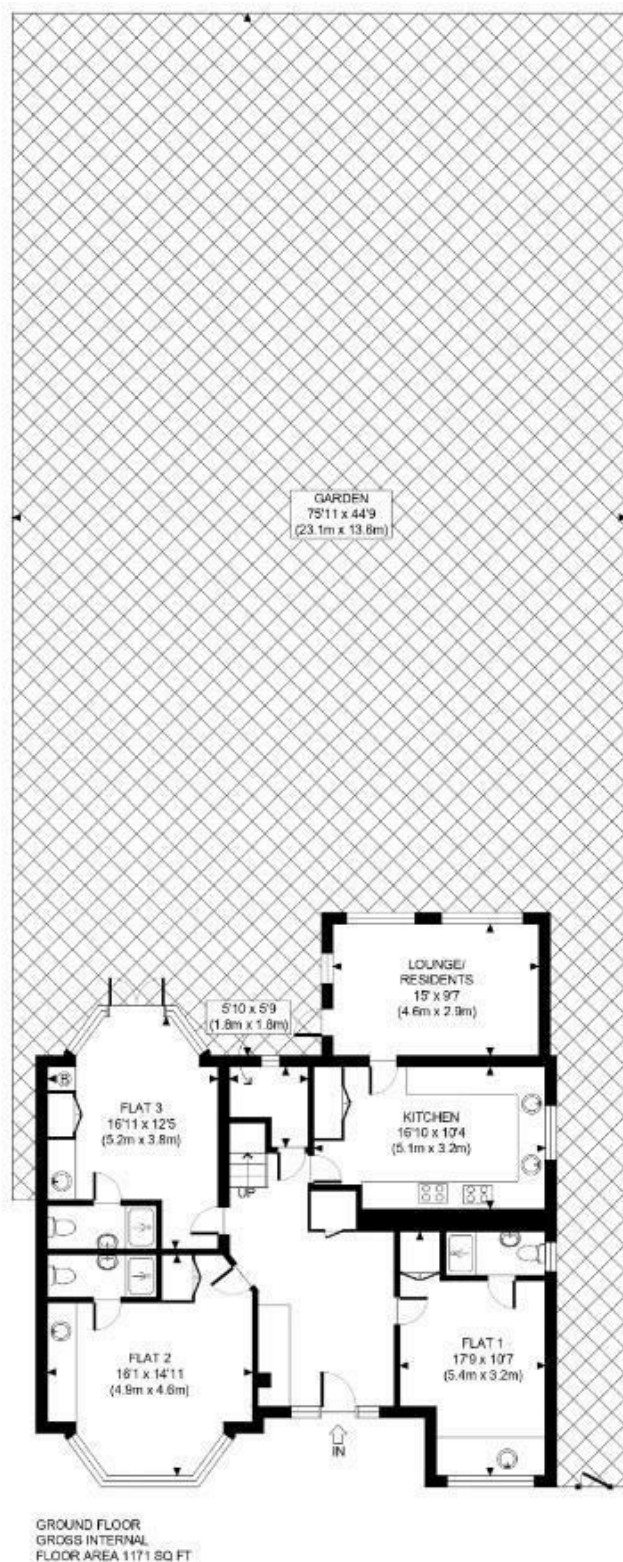

LOFT
GROSS INTERNAL
FLOOR AREA WITH EAVES STORAGE 486 SQ FT
FLOOR AREA WITHOUT EAVES STORAGE 410 SQ FT



APPROX. GROSS INTERNAL FLOOR AREA WITH EAVES STORAGE: 2677 SQ FT/ 249 SQM
APPROX. GROSS INTERNAL FLOOR AREA WITHOUT EAVES STORAGE: 2601 SQ FT/ 242 SQM

Rolfe East

This plan is for illustrative purposes only and should be used as such by any prospective client. Whilst every attempt has been made to ensure the accuracy of the Floor Plan contained here, measurements of the doors, windows, rooms and any other items are approximate and no responsibility is taken for any errors, omissions, or misstatement. The services, systems and appliances shown have not been tested and no guarantee as to the operability or efficiency can be given.

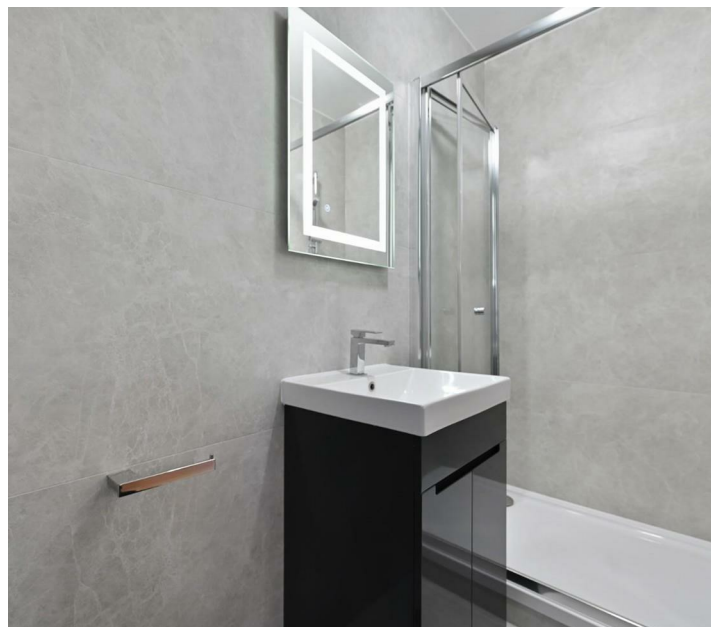



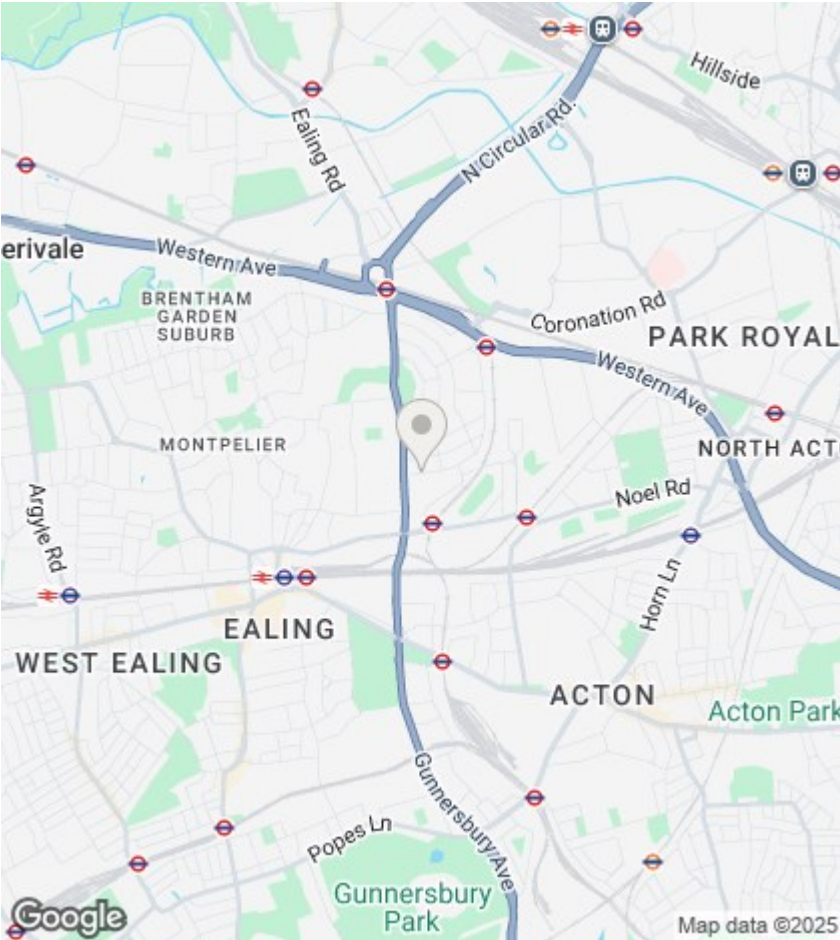

Directions

Viewings

Viewings by arrangement only. Call 020 8840 7707 to make an appointment.

EPC Rating:
D

